

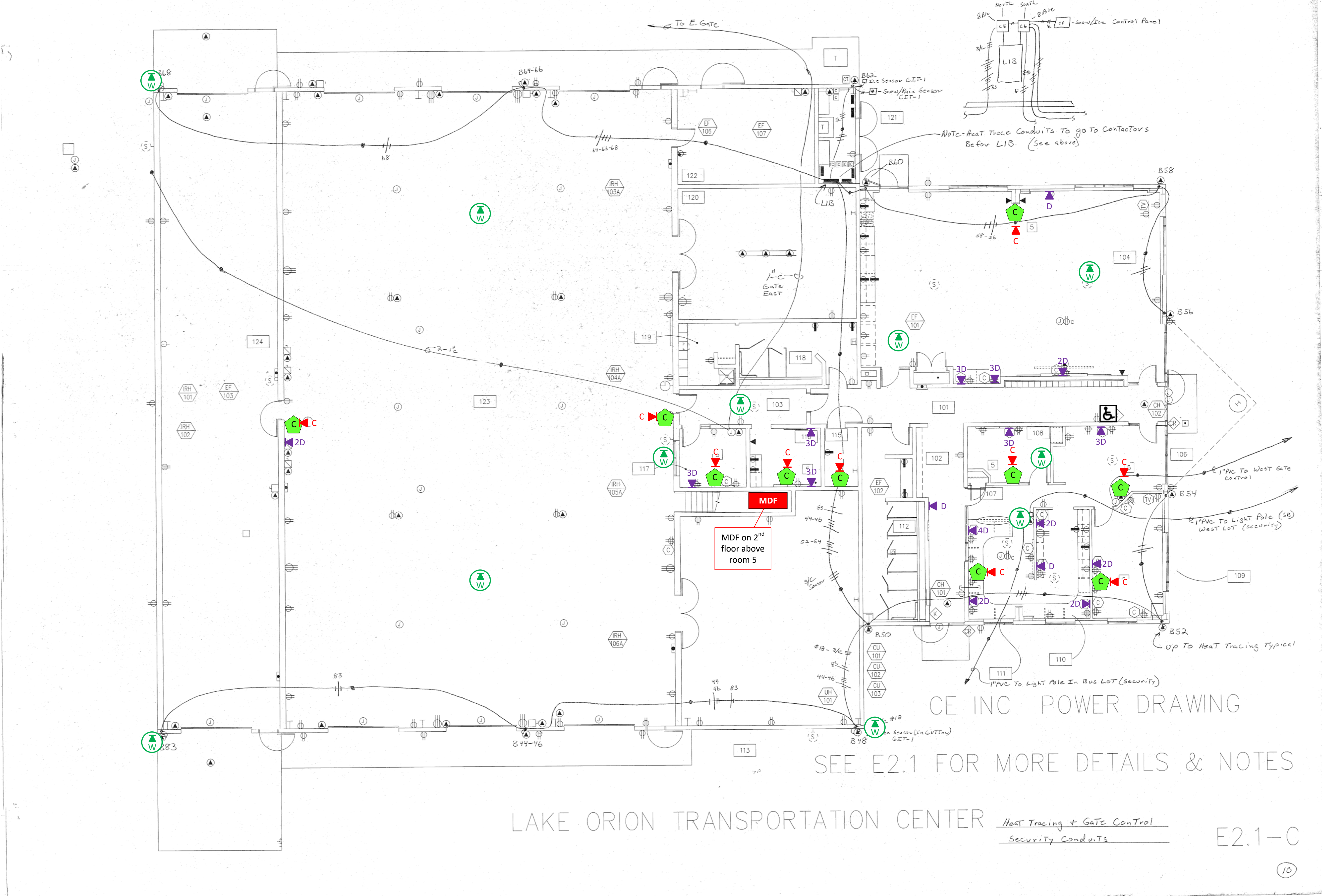

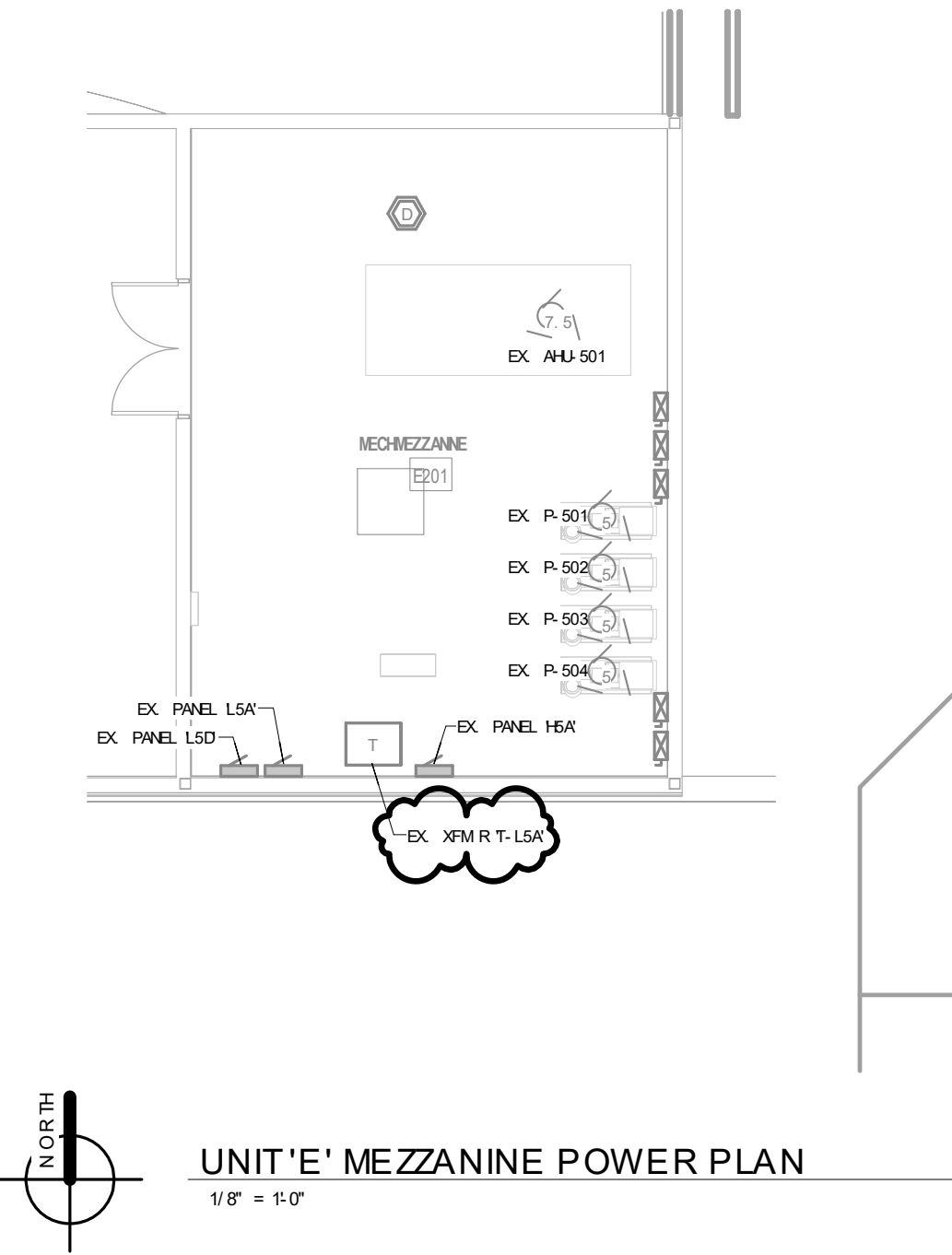







APPENDIX B - PRINTS

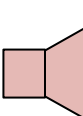

POWER GENERAL NOTES

1. REFER TO ELECTRICAL GENERAL NOTES ON SHEET BD-01.
2. REFER TO CODE COMPLIANCE PLAN FOR LOADINGS AND RATINGS OF ELECTRICAL AND FIRE PROTECTION. ASSEMBLIES PROVIDED ARE APPROXIMATE FIRE RATING SYSTEMS PER SPECIFICATIONS TO MEET ALL APPLICABLE CODES.
3. ALL GROUNDING USE 16- AND 20-MIL PER 125- AND 250-KVOLT NON-LOADING RECEPTABLES SHALL BE TAP PER RESISTANT TYPE. REFER TO NEC 408.12 AND SPECIFICATION SECTION 26.27.26.
4. PROVIDE 120VAC POWER FOR ALL SINGLE-DWELL AND COMBINATION THREE-PHASE DWELLERS.
 - A. CONNECT TO DERIVED 208V BRANCH CIRCUIT (WITH BREAKER LOAD ON ACCESSORY PANEL OR PANELS AND FIDELITY DWELLERS) IN EACH AREA. (DWELLERS MAY BE GROUPED ON EACH CIRCUIT).
 - B. TERMINATE WITH 20-KV-CLASS FIDELITY DISCONNECT SWITCH AT EACH DWELLER.
 - C. PROVIDE FIRE ALARM DETECTOR WITHIN 5 FEET OF EACH DWELLER (UNLESS OTHERWISE SPECIFIED DETECTOR WITHIN 5 FEET).
 - D. PROVIDE FIRE ALARM ADDRESSABLE RELAYS FOR INTERLOCKING DWELLERS WITH CORRESPONDING HANDLERS PER CODE REQUIREMENTS.
5. PROVIDE BOX COVER PLATES DISCONNECT SWITCHES ON BUILDING INTERIOR IN ACCESSIBLE LOCATION FOR EACH SHALL < 1 1/2 PSI MECHANICAL AND/OR PLUMBING EQUIPMENT NOT TO EXCEED WHERE MORE THAN ONE UNIT IS CONNECTED TO A COMMON BRANCH CIRCUIT. TYPE OF EQUIPMENT SHALL INCLUDE BUT NOT BE LIMITED TO: CABINET HEATERS, DWELLERS, EXHAUST FANS, FAN COIL UNITS, PUMPS, UNIT HEATERS, AIR EXHAUST, ETC.
6. DESIGNATED CABLE PATHWAYS (CONDUITS, CABLE TRAYS, PENETRATIONS, RISEWAYS, ETC.) SHALL BE PROVIDED FOR V. 27 COMMUNICATIONS CABLES AND V. 28 SAFETY SECURITY CABLES ONLY. OTHER CABLE TYPES, SUCH AS V. 23 COMMUNICATIONS, V. 26 COMMUNICATIONS, AND ARCHITECTURAL EQUIPMENT CABLES, SHALL BE SUPPORTED AND RIGGED BY OTHER INDEPENDENT PATHWAYS, HANDS, AND SUPPORTS.
7. CONDUIT ALL POWER SUPPLIES REQUIRED FOR ELECTRICAL CODE REQUIREMENTS (PER SECTION 08.71.00) TO CENTRAL LOCATION, ADJACENT TO DESIGNATED ACCESS CONDUIT IN ACCESSIBLE LOCATION. CONNECT ALL POWER SUPPLIES TO DERIVED LOCAL BRANCH CIRCUITS AS DESIGNATED.
8. CONDUIT THE INSTALLATION AND ROUTING OF EQUIPMENT (BOXES, CONDUITS, ETC.) IN WALLS AND CEILING SHALL BE THE FOLLOWING SYSTEMS WITH COMMUNICATIONS AND ELECTRICAL SAFETY SECURITY CONDUITS AND END AS SEPARATE BRANCHES (NOT IN THE CONDUIT), INCLUDING BUT NOT LIMITED TO:
 - A. NETWORK CABLES SYSTEMS
 - B. NETWORK ELECTRICAL SWITCHES, ACCESS POINTS, ETC.
 - C. TELEPHONE SYSTEMS
 - D. NETWORK CABLE TRAYING SYSTEMS
 - E. AUDIO-VISUAL SYSTEMS AND EQUIPMENT
 - F. NETWORK DIGITAL SIGNALING SYSTEMS AND DISPLAYS
 - G. NETWORK MANAGEMENT SYSTEMS
 - H. DISTRIBUTED LOCAL SYSTEM
 - I. ACCESS CONTROL SYSTEMS
 - J. INTERCOM DETECTION SYSTEM
 - K. VIDEO SURVEILLANCE SYSTEM
9. AT ALL UNDESIRABLE LOCATION, V. 26 COMMUNICATIONS SHALL PROVIDE FLUOROPOLYMER TWO-CONDUCTOR WITH 3/4" CONDUIT BURIED UP TO ACCESSIBLE SPACE AND BE SUPPORTED BY SEPARATE BRANCHES (N.I.C.). DESIGATED CABLES WILL BE INSTALLED BY SEPARATE BRANCHES (N.I.C.).
10. AT ALL UNDESIRABLE LOCATION, V. 26 COMMUNICATIONS SHALL PROVIDE FLUOROPOLYMER TWO-CONDUCTOR WITH 3/4" CONDUIT BURIED UP TO ACCESSIBLE SPACE AND BE SUPPORTED BY SEPARATE BRANCHES (N.I.C.).
11. REVIEW ALL OTHER DISCIPLINE PLANS FOR AREAS WHERE REMOVAL AND REINSTALLATION OF EXISTING CEILING IS WILL BE REQUIRED TO ACCOMMODATE THE DEMOLITION AND INSTALLATION OF EQUIPMENT, PIPING, AND STRUCTURE.
 - A. PROVIDE TEMPORARY SUPPORT, DEMOLITION, OR REMOVAL OF ALL EXISTING ELECTRICAL AND ELECTRICAL SAFETY SECURITY ITEMS TO UNDESIRABLE LOCATION. REINSTALL THE SAME ITEMS TO MATCH EXISTING CONDUIT WHERE CEILING IS REINSTALLED.
 - B. CONDUIT WITH OTHER TRUNKS TO MODIFY ANY ITEMS ABOVE CEILING SHALL BE REQUIRED TO ADD NEW DUAL INSTALLATION, INCLUDING BUT NOT LIMITED TO CONDUIT, JUNCTION BOXES, CABLE PATHWAYS, ETC.
 - C. RELOCATE EXISTING WORK REQUIRED, NOT ALL ITEMS ARE SHOWN ON DRAWINGS.
 - D. CONDUIT WITH CONDUIT IN MANHOLE REPAIRS.

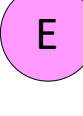
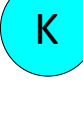

| Technology Design | |
|---|--|
|  | General Data Cable NEW (1 per location unless otherwise noted) |
|  | General Data Cable MOVE (1 per location unless otherwise noted) |
|  | Wireless Access Point Data Cable (1 per location unless otherwise noted) |
|  | Audio/Visual Data Cable (1 per location unless otherwise noted) |
|  | Clock Data Cable (1 per location unless otherwise noted) |
|  | Interactive Flat Panel |
|  | Classroom Audio |
|  | Audio Speaker |
|  | Clock |
|  | Card Reader |
|  | Event Card Reader |
|  | Keypad Card Reader |

Division of responsibilities for data installation

- Provided and installed by District
- Provided and installed by construction
- Provided and installed by cabling vendor

Demo Responsibilities: Demo existing low-voltage cabling, including UTP, COAX, analog/telephone wire at Transportation Building.

